



● Thank you for purchasing the KOSO Knight LED Bar End . Before installing, please read the instruction carefully and keep it for future reference.

## ⚠ ATTENTION!

- For installation, please follow the steps described in manual. Any damage caused by wrong installation shall be imputed to the users.
- Don't break or modify the wire. To avoid the short circuit, please don't pull the wire when installing.
- Do not disassemble or change any parts excluding the manual description.
- The interior examination or maintenance should be executed by our professionals.

### ◎ MARK MEANING:

**NOTE** You could get the installation details from the information behind the mark.

⚠ Some processes must be followed to avoid the affection caused by wrong installation.

⚠ **WARNING!** Some processes must be followed to avoid damages to yourself or the public.

⚠ **CAUTION!** Some processes must be followed to avoid the damage to the vehicle.

📖 **READ CAREFULLY!** If any information dealt with in the manual remains unclear seek professional assistance.

## 1-1 Accessories

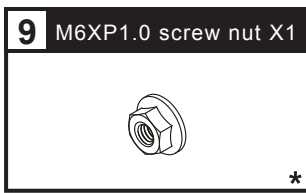
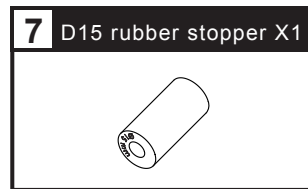
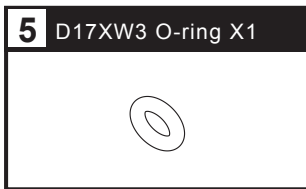
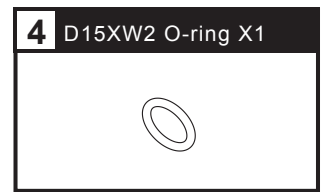
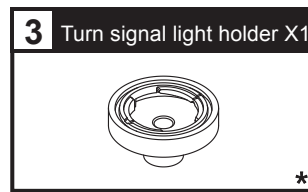
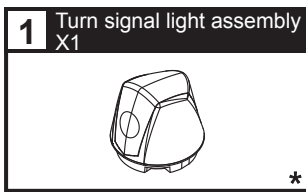

**NOTE** \* Indicates that part has been mounted onto the assembly.

**NOTE** Please contact your local distributor if the items received are not the same as the one listed above.

## 1-2 Optional Accessories

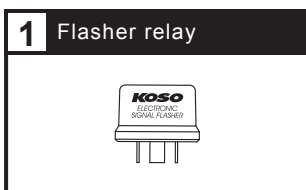

**NOTE** Some of these items may not sell in particular area, for more information, please contact with our local dealer.

## 2 Specifications

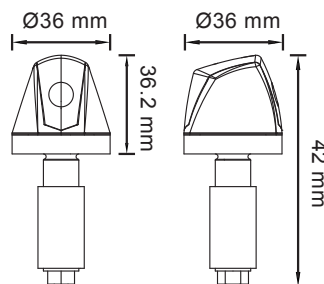

● Effective temperature range	-10 ~ 60 °C
● Standard	JIS D 0203
● Effective voltage	DC10 ~ 18 V
● Size	Ø 36 X H36.2 mm
● Weight	About 65.9 g

**NOTE** Design and specifications are subject to change without notice!

## 3-1 Installation instruction

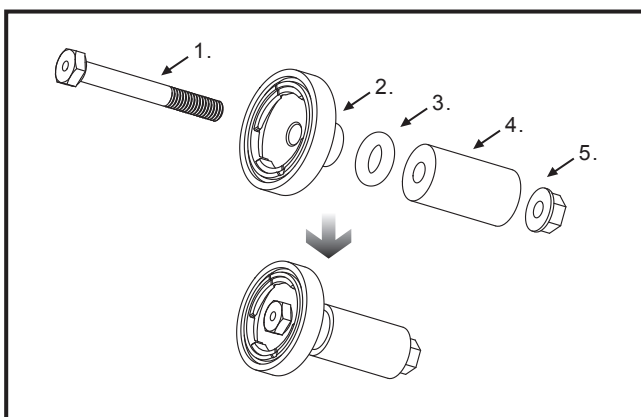

### Installation steps

1. M6X50L screw (Accessory 2)
2. Turn signal light holder (Accessory 3)
3. O-ring (Accessory 4~5)

**NOTE** Please refer to the table below to select the correct accessories according to the inner diameter of handlebar.

4. Rubber stopper (Accessory 6~8)

**NOTE** Please refer to the table below to select the correct accessories according to the inner diameter of handlebar.

5. M6XP1.0 screw nut (Accessory 9)

Inner diameter of handlebar	13mm	15mm	17mm
O-ring	X	D15XW2 (Accessory 4)	D17XW3 (Accessory 5)
Rubber stopper	D13 (Accessory 6)	D15 (Accessory 7)	D17 (Accessory 8)

## 3-2 Practical installation instruction

### Please proceed as follows

**⚠ CAUTION!** Total length of wiring is 800 mm. Please pay attention to the distance between the wire exit hole and the end of handlebar to avoid the occurrence of insufficient wire length.

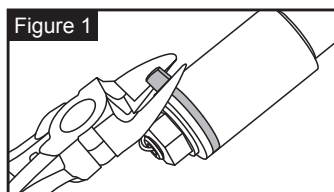

1. Please use proper tool to cut the cable tie.

**⚠ CAUTION!** Please be aware do not cut the power harness and rubber bush.

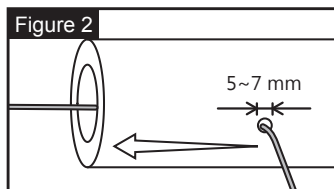

2. Please choose the position of wire exit hole and use an appropriate tool to drill a hole with approximately diameter of 5~7 mm in the handlebar.
3. Use a iron wire to pass through the wire exit hole outside-in and out from the end of handlebar.

**NOTE** Please use  $\leq 1$  mm iron wire.

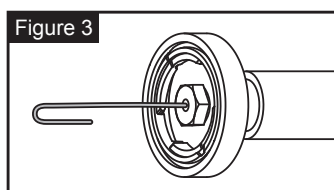

4. Lead the iron wire to pass through the screw (Accessory 2) from its end and out and bend it in U shape.

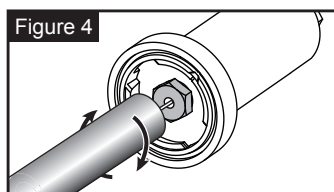

5. Please use and rotate a M10 socket to mount the holder to the handlebar.

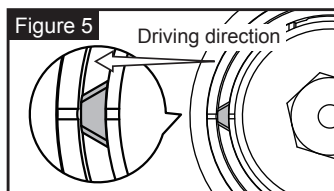

**NOTE** Arrowhead mark shall face the driving direction.

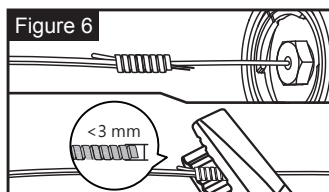

6. Wrap the iron wire and wiring with each other and then flatten them.

**NOTE** Total thickness shall not exceed 3mm after flattening.

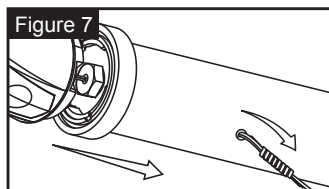

7. Pull the iron wire and wiring toward and out from the wire exit hole gently.

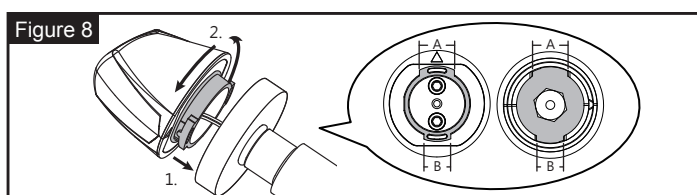

8. Integrate the turn signal light assembly and the holder together by rotating it all the way down to 90° clockwise.

**⚠ CAUTION!** When plugging in for rotation, A is the big end while B is the small end.

9. Pull out the remaining wire from the wire exit hole.

## 4 Wiring installation instructions

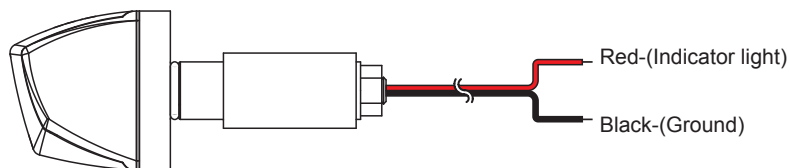

## 5 Trouble shooting

The following situation do not indicate malfunction of the meter. Please check the following before taking it in for repair.

Trouble	Check item
Turn signal light does not glow when activate.	<ul style="list-style-type: none"> <li>● Power supply cable disconnected. <ul style="list-style-type: none"> <li>→ Please check if power supply cable is broken or disconnected.</li> <li>→ Please check if positive and negative poles are properly connected.</li> </ul> </li> </ul>

※ If still can't solve the problems according to the step above, please contact with distributors or us.